

PUSH TROLLEY 1.0T (64-203MM)

Brand: **Austlift**

Product Code: **131010**

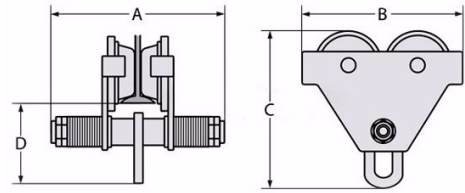

PUSH TROLLEY 1.0T (64-203MM)

This 1T Austlift Plain Trolley is moved by pushing the load lifted by the trolley, running along a flange of a monorail. A main shaft with spacers you can adjust the width of UB/UC beam. They are widely used in Factories, Mines, Wharves, Docks, Warehouses and Engineering Workshops for installation of equipment in places where no power supply is available.

Features:

- * High quality sealed ball bearings.
- * Identification tag with serial number.
- * Proof tested to 2 x WLL with certificate.
- * Fitted with anti-drop plates for safety.
- * Low headroom by design.
- * Complies to AS1418.2.

Specifications

Beam Flange Width	64 - 203 mm
Body Material	Steel
Dimension A	300 mm
Dimension B	236 mm
Dimension C	211 mm
Dimension D	115 mm
Mn. Radius of Curve	0.9 m
Weight	8.9 kg
WLL	1,000 kg (1.0T)