

## PUSH TROLLEY 3.0T (100-305MM)

Brand: **Austlift**

Product Code: **131020**

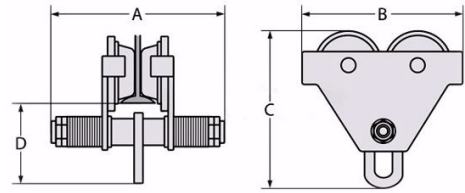

### PUSH TROLLEY 3.0T (100-305MM)

This 3T Austlift Plain Trolley is moved by pushing the load lifted by the trolley, running along a flange of a monorail. A main shaft with spacers you can adjust the width of UB/UC beam. They are widely used in Factories, Mines, Wharves, Docks, Warehouses and Engineering Workshops for installation of equipment in places where no power supply is available.

#### Features:

- \* High quality sealed ball bearings.
- \* Identification tag with serial number.
- \* Proof tested to 2 x WLL with certificate.
- \* Fitted with anti-drop plates for safety.
- \* Low headroom by design.
- \* Complies to AS1418.2.

If suspending a Pneumatic (Air) Operated Chain hoist from this Push trolley you will need Part# 503519 Safety Bow Shackle as the hooks on air operated chain hoists are larger than the ones on manual chain blocks and the hooks cannot fit correctly into the hanger block that comes with this particular 3T trolley.

#### Specifications

|                     |                 |
|---------------------|-----------------|
| Beam Flange Width   | 100 - 305 mm    |
| Body Material       | Steel           |
| Dimension A         | 420 mm          |
| Dimension B         | 320 mm          |
| Dimension C         | 295 mm          |
| Dimension D         | 164 mm          |
| Mn. Radius of Curve | 1.2 m           |
| Weight              | 24.3 kg         |
| WLL                 | 3,000 kg (3.0T) |