

PUSH TROLLEY 5.0T (100-305MM)

Brand: **Austlift**

Product Code: **131025**

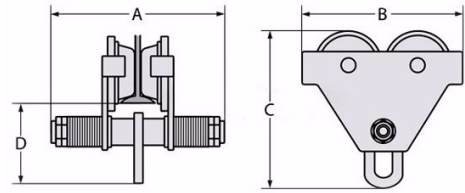

PUSH TROLLEY 5.0T (100-305MM)

This 5T Austlift Plain Trolley is moved by pushing the load lifted by the trolley, running along a flange of a monorail. A main shaft with spacers you can adjust the width of UB/UC beam. They are widely used in Factories, Mines, Wharves, Docks, Warehouses and Engineering Workshops for installation of equipment in places where no power supply is available.

Features:

- * High quality sealed ball bearings.
- * Identification tag with serial number.
- * Proof tested to 2 x WLL with certificate.
- * Fitted with anti-drop plates for safety.
- * Low headroom by design.
- * Complies to AS1418.2.

Specifications

Beam Flange Width	100 - 305 mm
Body Material	Steel
Dimension A	444 mm
Dimension B	366 mm
Dimension C	334 mm
Dimension D	177 mm
Mn. Radius of Curve	1.3 m
Weight	36.3 kg
WLL	5,000 kg (5.0T)